



## UPDATED RANCH IN DESIRABLE CENTRAL WEST ATHERTON

84 SERRANO DRIVE | ATHERTON | PRICE UPON REQUEST



This classic Atherton ranch has been beautifully updated and is perfectly located in central Atherton. Timeless elegance is paired with fresh updates, making the home ready to enjoy today while also offering an opportunity for further transformation. The level grounds, spanning over three-quarters of an acre, feature a stately privacy fence with brick columns and iron gates at each end of a circular driveway bordered by manicured boxwood hedges. Towering oaks enhance the setting. Inside, the freshly painted one-level home is classic and timeless with hardwood floors throughout, crown moldings, and wooden window shutters that add designer appeal. The formal living room is expanded by an adjoining sunroom opening to the rear grounds, and the formal dining room serves as a wonderful venue for entertaining. Extending beyond is a tremendous chef's kitchen and an adjoining family room that opens to the rear grounds and pool. Added amenities like a built-in desk center, island counter seating, and a fully customized walk-in pantry with an outside entrance to the garage add wonderful convenience.

The home features 4 bedrooms, 3 full baths, and 2 half-baths in the main residence, including a primary suite with a separate sitting room, an additional suite, plus two bedrooms with a shared bath. Adding to the accommodations is a delightful 1-bedroom, 1-bath guest house that doubles as a venue for poolside entertaining. The expansive rear grounds are quintessential for indoor/outdoor living with a sparkling pool. Additionally, a secluded sport court and putting green, plus a playground make this setting perfect for both relaxation and recreation.



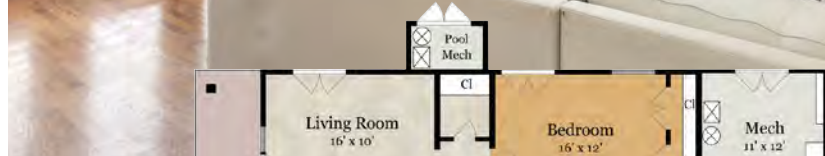

GUEST HOUSE



## SUMMARY OF THE HOME

- Classic Atherton ranch with fresh updates and opportunity to further transform
- 4 bedrooms, 3 full baths, and 2 half-baths in the main home
- 1-bedroom, 1-bath guest house
- Approximately 5,490 total square feet (per Floor Plan Visuals)
  - Main home: 3,910 square feet
  - Guest house: 625 square feet
  - 3-car garage: 770 square feet
  - Mechanical rooms: 185 square feet
- Main rooms: foyer; living room with fireplace; sun room; formal dining room; kitchen; casual dining area; family room
- Personal accommodations: primary bedroom suite; bedroom suite; two bedrooms with shared bath; two half-baths; guest house with one bedroom and one bath
- Freshly painted inside and out
- Hardwood floors throughout
- Detached 3-car garage and abundant off-street parking with gated circular driveway
- Pool plus secluded sport court, putting green, and playground
- Lot size of approximately 0.8943 acre (36,995 square feet)

Price upon request

[84Serrano.com](http://84Serrano.com)



SITE PLAN



**HUGH  
CORNISH**  
& ASSOCIATES

650.619.6461

hcornish@cbnorcal.com

CalRE#00912143

[WWW.HUGHCORNISH.COM](http://WWW.HUGHCORNISH.COM)

Over \$3.3 Billion in Sales

#1 Coldwell Banker Agent SF Bay Area

#98 Agent in the United States

per *RealTrends* 2024



**COLDWELL BANKER**  
REALTY