

PRIVATE WOODSIDE RETREAT BORDERING HUDDART PARK



890 PATROL ROAD, WOODSIDE

PRIVATELY TUCKED AWAY at the road's end, bordering the expansive 900-acre Huddart Park, this serene country home blends comfort with seclusion. Spanning approximately 1.71 acres of sunlit grounds stretching to Kings Mountain Road, the home harmonizes perfectly with nature. Whether a primary residence, just 2.5 miles from Woodside's town center, or a weekend escape from urban living, this home offers the utmost in tranquility with close-in convenience. A wellness center awaits at the entrance with a spacious spa set within a wood-paneled building encircled by shoji screen windows. For fitness, 23 miles of hiking, biking, and equestrian trails await at Huddart Park.

Inside, discover the rustic charm of this 3-bedroom plus office, 3-bath home adorned with pine wood on walls and ceilings, and hardwood floors in most rooms. The welcoming great room, flooded with natural light from clerestory windows and a glass-lined front alcove, seamlessly combines living, dining, and the kitchen. The main level has three bedrooms, including a primary suite with sweeping views of the redwoods and deck access. The fourth bedroom, with its own entrance, and a bath are on the lower level, along with a spacious project/laundry room. Added conveniences include a detached 2-car garage, plus access to acclaimed Woodside Elementary (K-8) School just over 2 miles away.

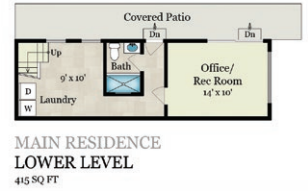

SITE PLAN



Kings Mountain Rd



Patrol Rd



AT A GLANCE

- Enchanting country home perfect for a primary or secondary residence
- Privately located at the end of the road bordering 900-acre Huddart Park
- Approximately 1.71 acres stretching to Kings Mountain Road
- 3 bedrooms, office or possible 4th bedroom, and 3 remodeled baths
- Approximately 2,095 square feet (per floor plan artist)
 - Main home: 1,575 sf
 - Spa: 120 sf
 - Garage: 400 sf
- Detached 2-car garage
- Detached spa building encircled with shoji screen windows
- Extensive use of pine wood on walls and ceilings plus hardwood floors in most rooms
- Great room for living, dining, and kitchen
- Main-level primary suite plus two bedrooms and bath
- Lower-level bedroom and bath plumbed for steam shower, plus project/laundry room
- Expansive side deck connects to a wraparound deck
- 2.5 miles to Woodside town center
- Excellent Woodside schools

Price upon request | www.890Patrol.com

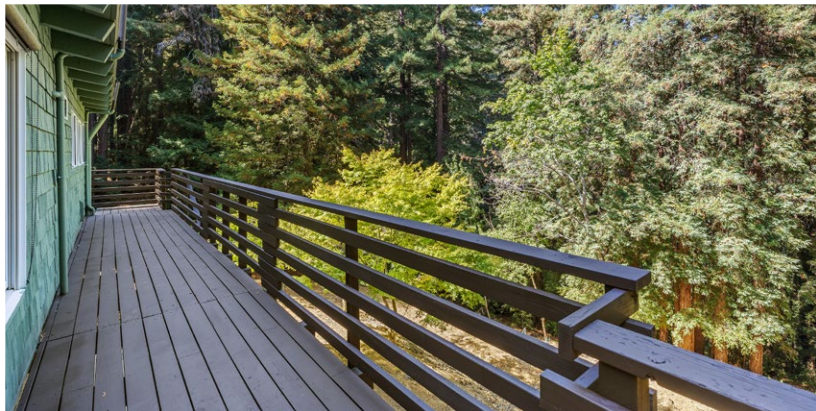

DETAILS OF THE PROPERTY

- A long driveway leads past natural walls of tall bamboo foliage culminating at the detached 2-car garage and sample turn-around space
- Walk past a cluster of redwoods to a footbridge leading to the glass front door and expansive entertainment deck to one side
- Just before the entertainment deck is a wood-paneled building with vaulted ceiling and shoji screen windows on all sides enclosing a large above-ground spa
- Great room for living, dining, and kitchen with walls and ceiling all in pine wood plus hardwood floors; a window-lined alcove at the front provides an added seating area with glass doors on two sides
- Kitchen has all pine cabinetry topped in Corian with glass tile backsplashes in a matching color; vaulted ceiling with clerestory windows
- Appliances include a GE gas range with 4 burners and griddle, Whirlpool dishwasher, and Whirlpool refrigerator
- Remodeled hallway bath in stone-like large format tile on the walls and floor plus glass mosaic accents; single-sink vanity, wall-hung commode, and tub with overhead shower
- Two carpeted bedrooms, each with organized mirrored closet and beamed and paneled wood ceiling with center light fixture
- Primary bedroom suite has hardwood floors, pine walls and vaulted ceiling with clerestory windows, mirrored closet, and wide sliding glass door to the wraparound deck; remodeled en suite bath has heated floor, stone-like large format tile finishes, Carrara marble topped furniture-style vanity, wall-hung commode, and curbless shower with pebblestone floor and partial frameless glass enclosure
- Carpeted lower-level office, or possible bedroom, with three walls in pine, expansive window, and sliding glass door to a covered rear patio and sun-swept meadow
- Lower-level bath, adjacent to a glass-paned door to the rear grounds, has tile wainscot and flooring, furniture-style vanity, and frameless-glass shower with body sprays and plumbing in place for steam
- Lower-level project/laundry room with large-format tiled floor, washer/dryer, and accent wall in pine
- Located at the end of the road on the edge of 900-acre Huddart Park with 23 miles of trails for hiking, biking, and equestrian use; 2.5 miles to Woodside town center
- Excellent schools: Woodside Elementary (K-8); Woodside High (9-12)

ERIKA DEMMA
REAL ESTATE SERVICES

ERIKA DEMMA
650.740.2970
erika@erikademma.com
DRE# 01230766
erikademma.com



HUGH CORNISH
650.619.6461
hcornish@cbtnorcal.com
DRE# 00912143
hughcornish.com

HUGH CORNISH
& ASSOCIATES

COMPASS



COLDWELL BANKER
REALTY