



## PRIVACY AND VIEWS OF THE WESTERN HILLS

167 RAMOSO ROAD | PORTOLA VALLEY | OFFERED AT \$5,495,000



**T**his private 2.54-acre property in the desirable Westridge area of Portola Valley boasts expansive views of the Western Hills. The possibilities for this wonderful property abound! Remodel the existing 6 bedroom, 5 bath, 4,125 square-foot ranch house, or build the home of your dreams. The 1957 mid-century modern home features all redwood walls and finishes throughout, with floor-to-ceiling windows, vaulted ceilings, and sliding glass doors that open to the exterior in almost every room. A wrap-around deck, multiple patios, and an in-ground pool offer ideal outdoor entertaining spaces.





- Private, gated 2.54-acre lot in desirable Westridge area of Portola Valley
- 6 bedrooms and 5 full baths; approx. 4,125 sq. ft.
  - Main level: 2,550 sq. ft.
  - Lower level: 1,230 sq. ft.
  - Wine cellar/storage: 140 sq. ft.
  - Mechanical room/shed: 205 sq. ft.
  - Storage: 880 sq. ft.
- Well-maintained, mid-century modern home
- Vaulted ceilings and floor-to-ceiling windows throughout
- Main level: living room, dining room, eat-in kitchen, master suite, two bedrooms, two full baths, and laundry room
- Lower level: two bedrooms, one full bath, office/library, wine cellar/storage, and a one-bedroom, one-bath in-law unit
- Hardwood floors in the main-level living areas and lower level, wall-to-wall carpet in all main-level bedrooms
- Redwood finishes throughout the home
- Detached 2-car carport with storage shed
- Multiple patios, wrap-around deck, and pool area are ideal for entertaining
- Excellent Portola Valley schools

**Offered at \$5,495,000**



**Estimated Total Finished  
Square Footage: 3,780 SQ FT**

Above-Grade: 2,550 SQ FT Below-Grade: 1,230 SQ FT  
 Plus 140 SQ FT Wine Cellar/Storage  
 Plus 35 SQ FT Mech Room  
 Plus 170 SQ FT Shed  
 Calculated per ANSI Standard Z765-2003.

\* Estimated Total Finished & Unfinished Square Footage: 4,125 SQ FT



For floor plans, additional photos and information,  
 please visit [www.167Ramoso.com](http://www.167Ramoso.com)

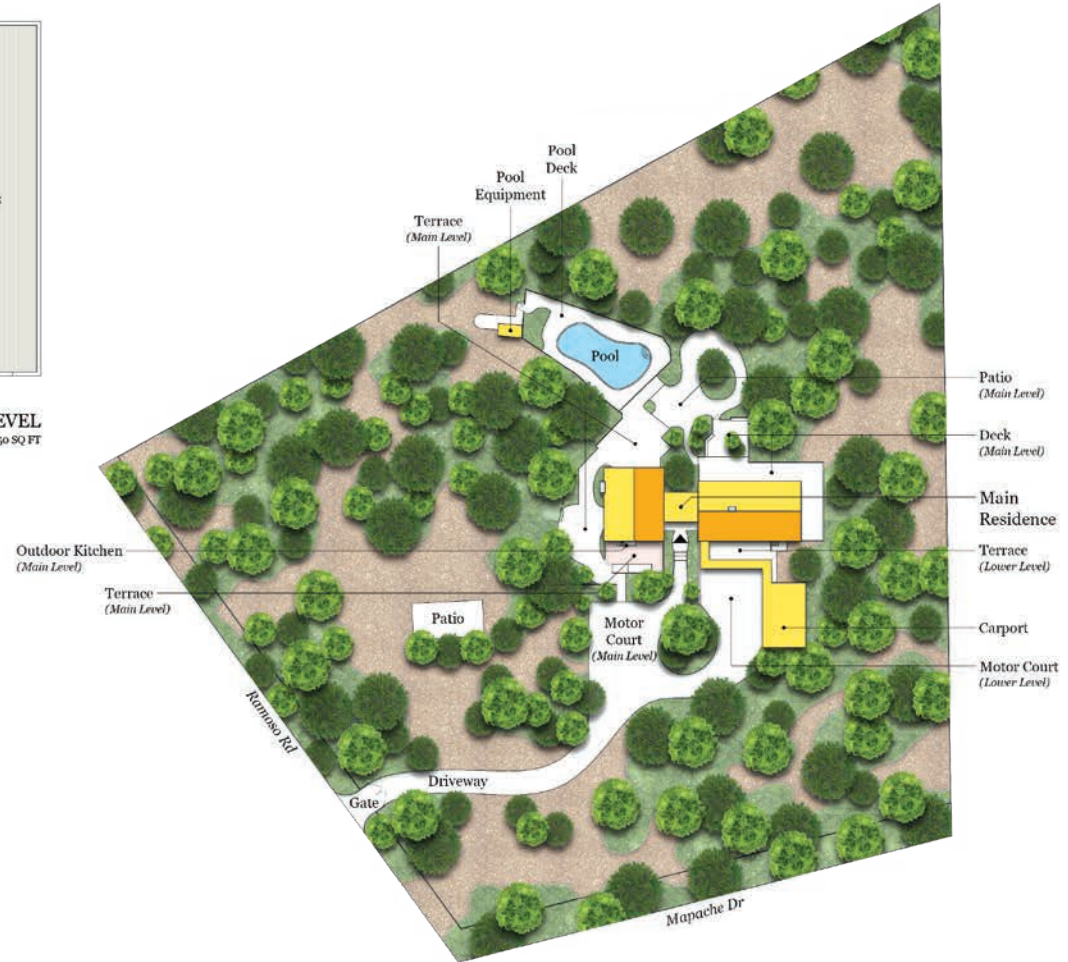

**HUGH  
 CORNISH**  
 & ASSOCIATES



**HUGH CORNISH**

650.619.6461  
 hugh@hughcornish.com  
 CalRE#00912143



**STEPHANIE ELKINS  
 VAN LINGE**

650.400.2933  
 stephanie@hughcornish.com  
 CalRE#00897565

**HughCornish.com**

Ranked Top 1% Internationally – Coldwell Banker  
 Ranked #210 Nationally by *The Wall Street Journal*, 2018  
 Over \$2 Billion in Sales



RESIDENTIAL BROKERAGE

**GLOBAL  
 LUXURY**