



*Close to Town, Out-of-the-way Location*



800 El Camino Real, Suite 300  
Menlo Park, CA 94025

PRSR STD  
U.S. Postage  
PAID  
Coldwell Banker



**HUGH CORNISH**

DRE #00912143

#1 Individual Agent, 2008 SF-Peninsula  
#8 Individual Agent, 2008 Nationally

**650-566-5353**

[hcornish@cbtnorcal.com](mailto:hcornish@cbtnorcal.com)

For more information on this property and others,  
please visit my Web site at:

**[WWW.HUGHCORNISH.COM](http://WWW.HUGHCORNISH.COM)**

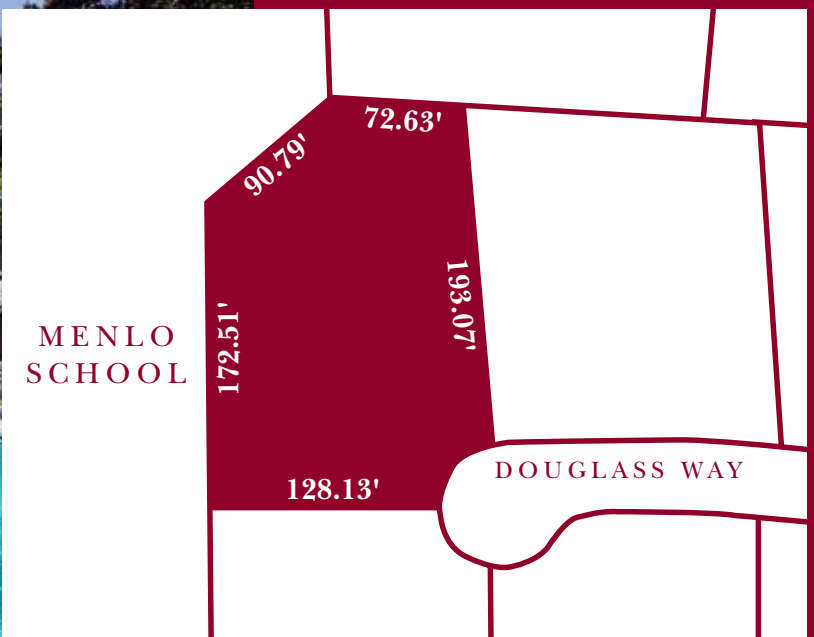

Photography by Cherie Cordellos. This information was supplied by Seller and/or other sources. Broker believes this information to be correct but has not verified this information and assumes no legal responsibility for its accuracy. Buyers should investigate these issues to their own satisfaction.



Welcome to this two-story, traditional home, set on approximately .75 of an acre at the end of a cul-de-sac close to Menlo School. Designed by Jonathan Jang, this lovely home offers charm, comfort, and complete privacy, with approximately 6,269 square feet of living space. The first floor incorporates a living room, dining room, family room, kitchen, two guest powder rooms, and two bedroom suites. On the second floor are three bedrooms and two full baths, including a sumptuous master suite with two walk-in closets and a study. In the rear garden the expansive patio links the swimming pool, spa, sport court, and picturesque gazebo. The detached three-car garage has a full floor of attic space and is connected to the house by a breezeway. Menlo Park schools.

*Price upon request*



### *Summary*

- Five bedrooms, five full baths and two half-baths
- Living room, dining room, family room, and updated kitchen
- Mature garden with patio, pool, spa, sport court, and gazebo
- Top-rated Menlo Park Schools